

PRIME RETAIL SPACE FOR LEASE AURORA
330 McClellan Way,
Aurora, Ontario

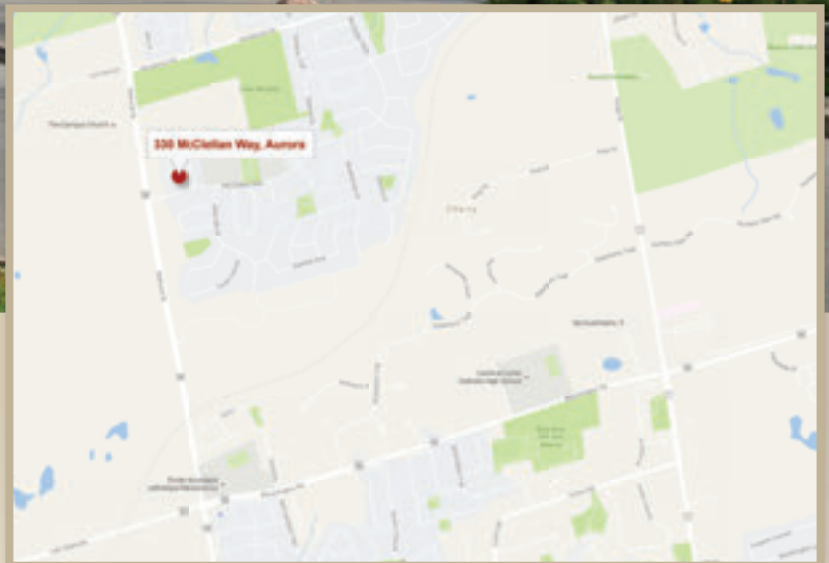

Michael Pearlman
Vice President,
Sales Representative
(416) 567-5101
pearlmanmichael@gmail.com

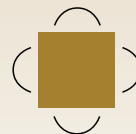

Goudy Real Estate Corp.
Real Estate Brokerage
Commercial Real Estate
Sales & Leasing

505 Hood Rd., Unit 20, Markham, ON L3R 5V6 | **(905) 477-3000**

The information contained herein has been provided to Goudy Real Estate Corp. by others. We do not warrant its accuracy. You are advised to independently verify the information prior to submitting an Offer and to provide for sufficient due diligence in an offer. The information contained herein may change from time to time without notice. The property may be withdrawn from the market at any time without notice.

330 MCCLELLAN WAY, AURORA

Site Details



Details:

- Shopping Centre has undergone an exterior modernization to the Façade this past year.
- New Pylon Sign installed 2018.
- The Plaza is located just off of Bathurst Street in Aurora and is surrounded by residential.
- The average household income in the area is approximately double the Canadian Average.
- Ample Parking
- There are new Homes being constructed nearby
- Retail Zoning
- Just off the Corner of McClellan Way and Bathurst
- Minimum Rents Starts @ \$23.00sf Triple Net Plus Taxes + Operating Costs Estimated @ \$9.45sf.

330 MCCLELLAN WAY, AURORA Site Plan

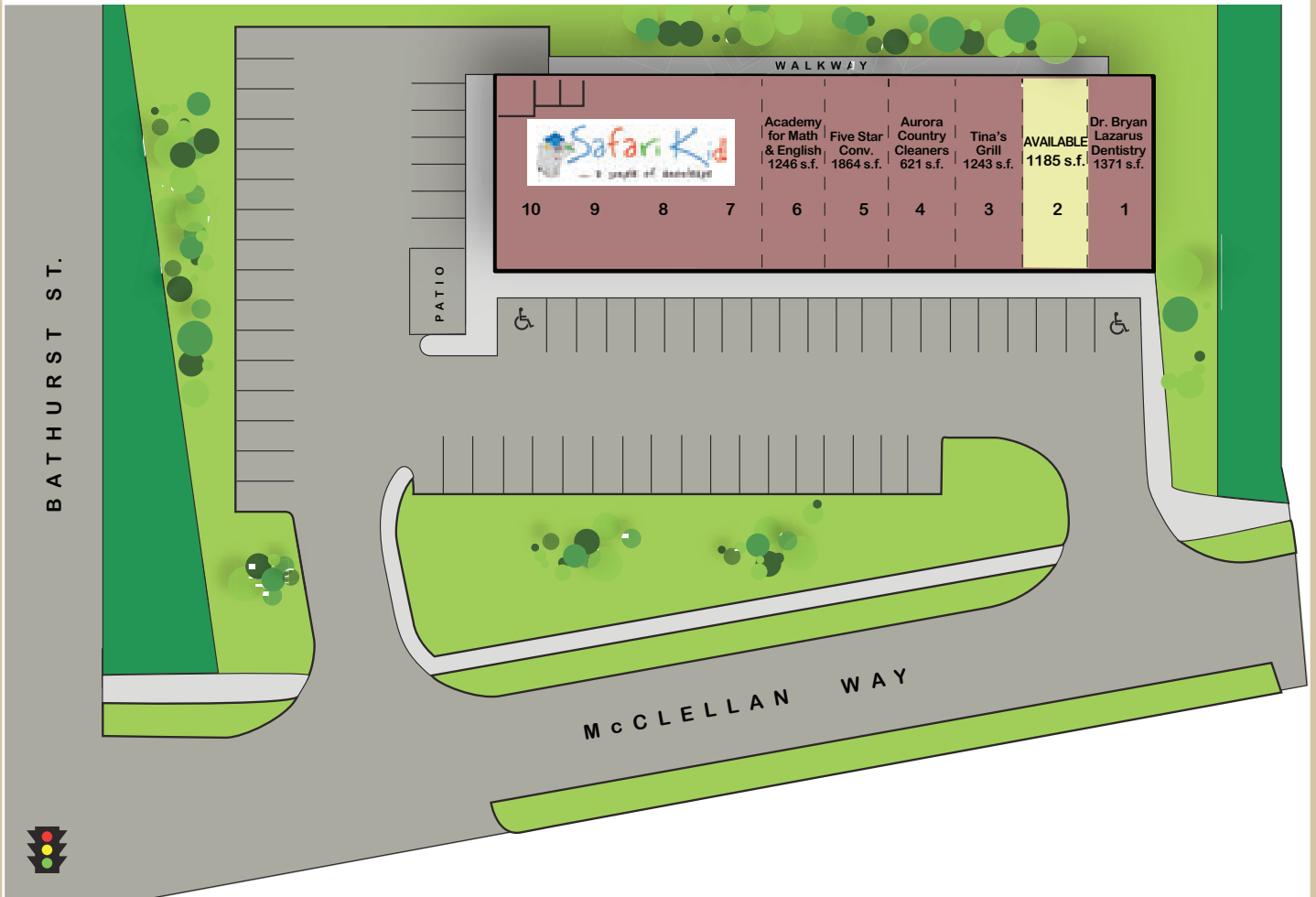

Unit Available: Unit 7 - 1,185sf approximately

- Minimum Rent Starts @ \$23sf triple net Plus Taxes + Operating Costs estimated @ \$9.45sf

330 MCCLELLAN WAY, AURORA

Demographics

2013 Demographic Snapshot	330 McClellan Way, Aurora ON 1 kilometer ring		330 McClellan Way, Aurora ON 3 kilometer ring		330 McClellan Way, Aurora ON 5 kilometer ring	
		%		%		%
Total Population						
2008 estimated	4,130		26,118		62,400	
2013 estimated	4,075		26,096		68,481	
2018 projected	4,335		27,970		73,584	
% Pop. Change (2008-2013)	-1.3%		-0.1%		9.7%	
% Pop. Change (2013-2018)	6.4%		7.2%		7.5%	
2013 Total Population by Age	4,075		26,096		68,481	
0 to 4 years	135	3.3%	1,144	4.4%	3,605	5.3%
5 to 19 years	1,083	26.6%	5,951	22.8%	14,758	21.6%
20 to 24 years	417	10.2%	2,056	7.9%	4,872	7.1%
25 to 34 years	327	8.0%	2,427	9.3%	6,942	10.1%
35 to 44 years	434	10.7%	3,411	13.1%	10,086	14.7%
45 to 54 years	968	23.8%	5,120	19.6%	12,567	18.4%
55 to 64 years	476	11.7%	3,225	12.4%	7,963	11.6%
65 to 74 years	152	3.7%	1,520	5.8%	4,188	6.1%
75 years & over	83	2%	1,243	5%	3,500	5%
Median Age	37.4		40.1		39.6	
2013 Total Census Families	1,060		6,993		18,383	
Average Persons Per Family	3.4		3.3		3.3	
Total Couples	913	86.1%	6,129	87.6%	16,159	87.9%
Without children at home	228	21.5%	1,938	27.7%	5,020	27.3%
With children at home	684	64.6%	4,191	59.9%	11,139	60.6%
Lone-parent families	147	13.9%	864	12.4%	2,225	12.1%
Children Per Census Family	1.5		1.3		1.3	
2013 Educational Attainment (15 years+)	3,304		21,007		54,571	
Less than a bachelor degree	2,214	67.0%	14,677	69.9%	37,674	69.0%
Bachelor degree & higher	1,090	33.0%	6,330	30.1%	16,897	31.0%
2013 Households	1,184		8,372		22,181	
Persons per household	3.38		3.08		3.04	
Average household income	\$ 148,504		\$ 135,639		\$ 140,999	
2013 Occupied Dwellings	1,184		8,372		22,181	
Owned dwellings	1,084	91.6%	7,267	86.8%	19,537	88.1%
Rented dwellings	100	8.4%	1,104	13.2%	2,644	11.9%
Dominant building type	Houses		Houses		Houses	
Dominant period of construction	1991-1995		1986-1990		2001-2006	
Dominant Demographics						
Official Home Language	English		English		English	
Non-official Home Language	Italian		Italian		Italian	
Top 3 visible minorities	South Asian Black Chinese		South Asian Black Chinese		Chinese South Asian West Asian	