

RETAIL SPACE AVAILABLE FOR LEASE
1120 Caledonia Road
Toronto, Ontario

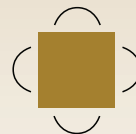

Len Goudy

Broker of Record
Goudy Real Estate Corp.
Real Estate Brokerage
(416) 830-0880



Goudy Real Estate Corp.
Real Estate Brokerage
Commercial Real Estate
Sales & Leasing

505 Hood Rd., Unit 20, Markham, ON L3R 5V6 | (905) 477-3000
www.goudyrealestatecorp.com

The information contained herein has been provided to Goudy Real Estate Corp. by others. We do not warrant its accuracy. You are advised to independently verify the information prior to submitting an Offer and to provide for sufficient due diligence in an offer. The information contained herein may change from time to time without notice. The property may be withdrawn from the market at any time without notice.

1120 CALEDONIA ROAD

Aerial and Details of Site

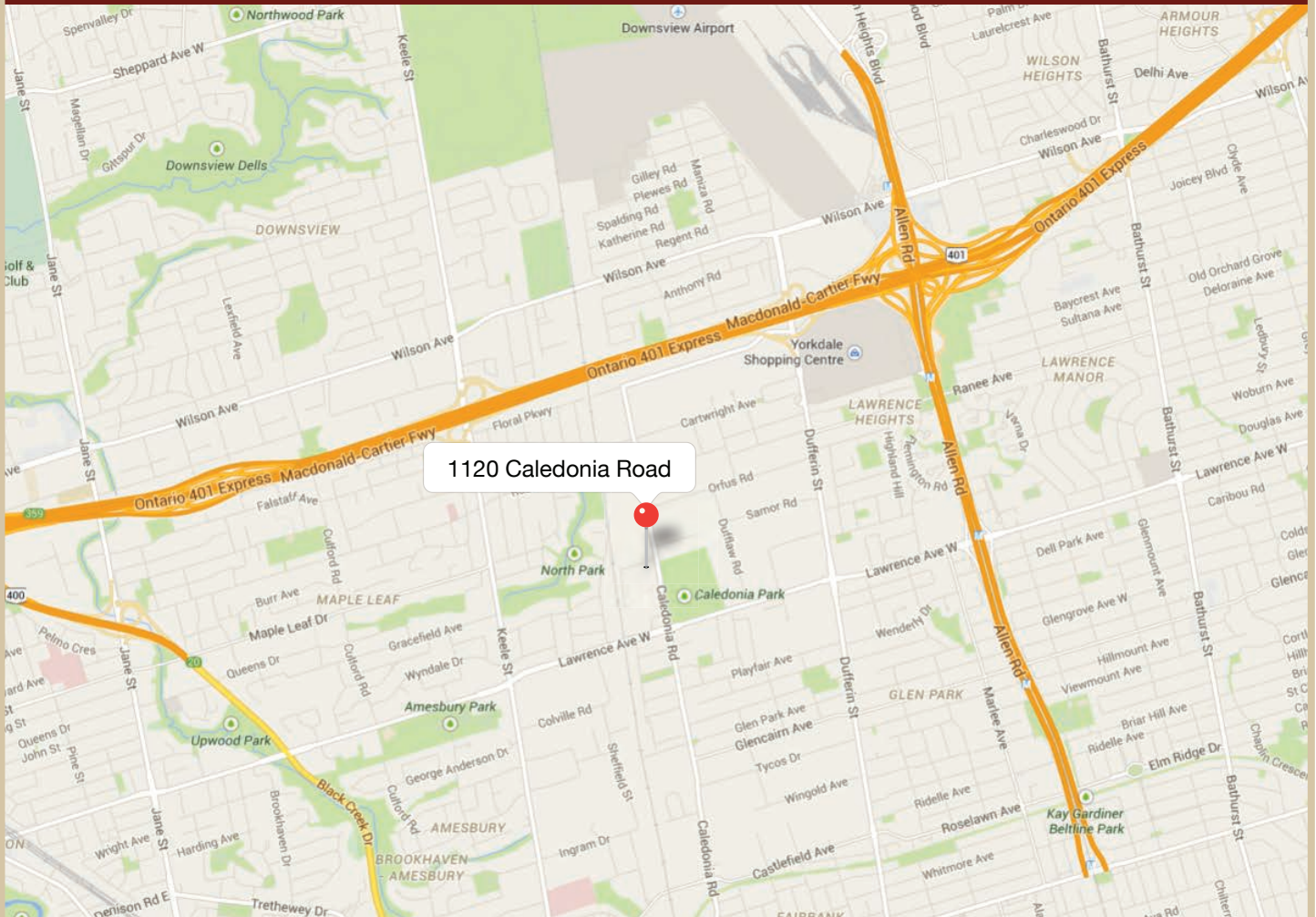

Features:

- 1120 Caledonia Road situated on Caledonia Road, just north of Lawrence Ave.
- There are 57,028 Daytime Workers within 3 kms, and 124,003 persons living within this primary trade area.
- Close proximity to Yorkdale
- Close to Orfus Road fashion outlet strip
- Close to many home décor shops
- Close to numerous specialty home improvement shops
- Ideal opportunity for any of the above uses

Available:

Unit B2: 4,973 s.f. with 49 ft. 7 in. of frontage. Rent \$17.00 p.s.f. p.a. net; TMI \$4.60 p.s.f., p.a.

1120 CALEDONIA ROAD Site Plan

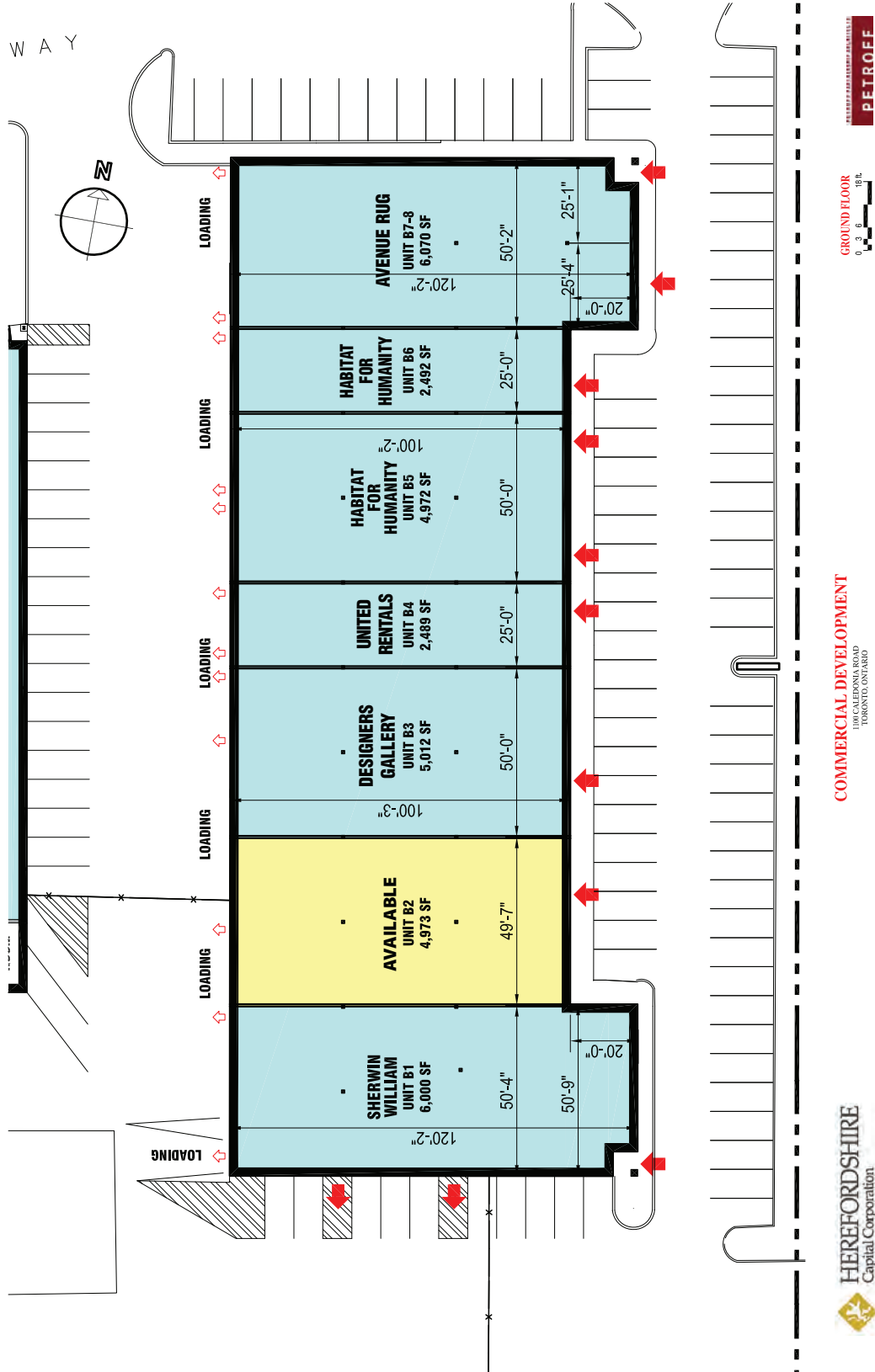

HEREFORDSHIRE
Capital Corporation

COMMERCIAL DEVELOPMENT
1100 CALEDONIA ROAD
TORONTO, ONTARIO

GROUND FLOOR
0 3 6 18 ft.

PETROFF

1120 CALEDONIA ROAD

Trade Area Demographics

2018 Demographic Snapshot	1120 Caledonia Rd, North York, ON M6A 2W5 0 - 3 km		1120 Caledonia Rd, North York, ON M6A 2W5 0 - 5 km	
		%		%
Total Population				
2013 estimated	119,040		376,081	
2018 estimated	124,003		390,372	
2023 Projected	129,380		405,280	
% Pop. Change (2013-2018)	4.2%		3.8%	
% Pop. Change (2018-2023)	4.3%		3.8%	
2018 Total Population by Age	124,003		390,372	
0 to 4 years	7,141	5.8%	22,946	5.9%
5 to 19 years	19,733	15.9%	61,566	15.8%
20 to 24 years	8,654	7.0%	26,469	6.8%
25 to 34 years	16,871	13.6%	53,367	13.7%
35 to 44 years	18,595	15.0%	59,973	15.4%
45 to 54 years	17,168	13.8%	54,944	14.1%
55 to 64 years	15,419	12.4%	50,214	12.9%
65 to 74 years	9,560	7.7%	31,409	8.0%
75 years & over	10,861	9%	29,483	8%
Median Age	39.8		39.9	
2018 Total Census Families	31,514		99,529	
Average Persons Per Family	3.1		3.2	
Total Couples	22,386	71.0%	74,123	74.5%
Without children at home	8,553	27.1%	28,032	28.2%
With children at home	13,832	43.9%	46,091	46.3%
Lone-parent families	9,128	29.0%	25,406	25.5%
Children Per Census Family	1.3		1.3	
2018 Educational Attainment (15 years+)	102,127		322,046	
Less than a bachelor degree	80,581	78.9%	233,695	72.6%
Bachelor degree & higher	21,546	21.1%	88,351	27.4%
2018 Households	46,966		148,732	
Persons per household	2.60		2.60	
Average household income	\$ 83,908		\$ 113,506	
2018 Occupied Dwellings	46,966		148,732	
Owned dwellings	22,707	48.3%	79,042	53.1%
Rented dwellings	24,258	51.7%	69,689	46.9%
Total Daytime Population	122,309		365,217	
Daytime Population at Home	65,281	53.4%	199,467	54.6%
0 to 14 years	20,075	16.4%	63,943	17.5%
15 to 64 years	28,443	23.3%	85,418	23.4%
65 years and over	16,763	13.7%	50,106	13.7%
Daytime Population at Work	57,028	46.6%	165,751	45.4%
Work At Usual Place	47,447	38.8%	135,583	37.1%
Work Mobile	7,087	5.8%	18,836	5.2%
Work At Home	2,494	2.0%	11,331	3.1%