

# OFFICE SPACE FOR LEASE

1685 MAIN STREET WEST, HAMILTON, ONTARIO



## Richard Greville

Sales Representative  
Goudy Real Estate Corp.  
Real Estate Brokerage  
**(905) 308-2406**

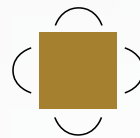

**Goudy Real Estate Corp.**  
Real Estate Brokerage  
Commercial Real Estate  
Sales & Leasing

505 Hood Rd., Unit 20, Markham, ON L3R 5V6 | **(905) 477-3000**

The information contained herein has been provided to Goudy Real Estate Corp. by others. We do not warrant its accuracy. You are advised to independently verify the information prior to submitting an Offer and to provide for sufficient due diligence in an offer. The information contained herein may change from time to time without notice. The property may be withdrawn from the market at any time without notice.

# FLOOR PLAN & AREA DETAILS

## 1685 MAIN STREET WEST

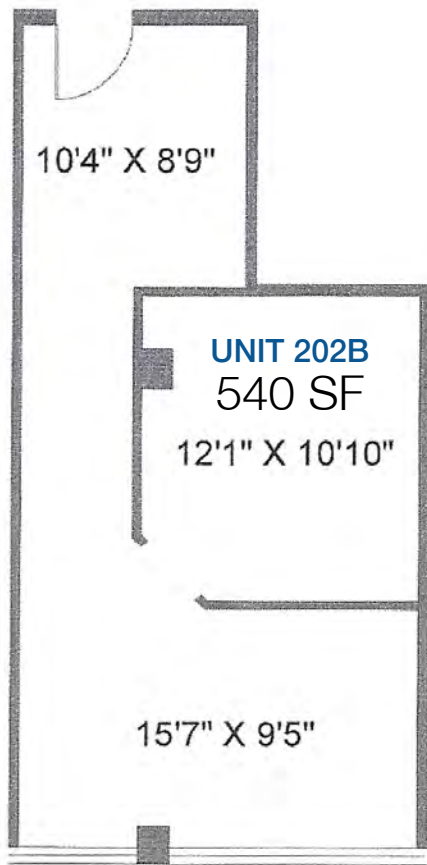

### EXISTING OPPORTUNITIES!

Join Crunch Fitness, Little Caesars, Baskin Robbins, BioPed, BOOSTER JUICE, Popeye's Chicken, CAA, Fast Signs and a hair salon in this strategically located plaza at the gateway to West Hamilton, Dundas and Ancaster plus McMaster University is only about a 5 minute drive. Serving the surrounding residents and McMaster University students, this plaza is a mix of retail, financial, medical/dental, fitness and accounting tenants.

### Features:

- Located at the signalized intersection which is the gateway to West Hamilton, Dundas and Ancaster
- 450 unit student residence directly across the road, high school within walking distance
- McMaster University and McMaster Hospital 5 minutes away
- Excellent exposure to intersection

### Office Space Available:

**Unit 202B:** 540 sq. ft.

**Unit 202C:** 657 sq. ft.

\*These two units can be combined

# TRADE AREA MAP

## 1685 MAIN STREET WEST

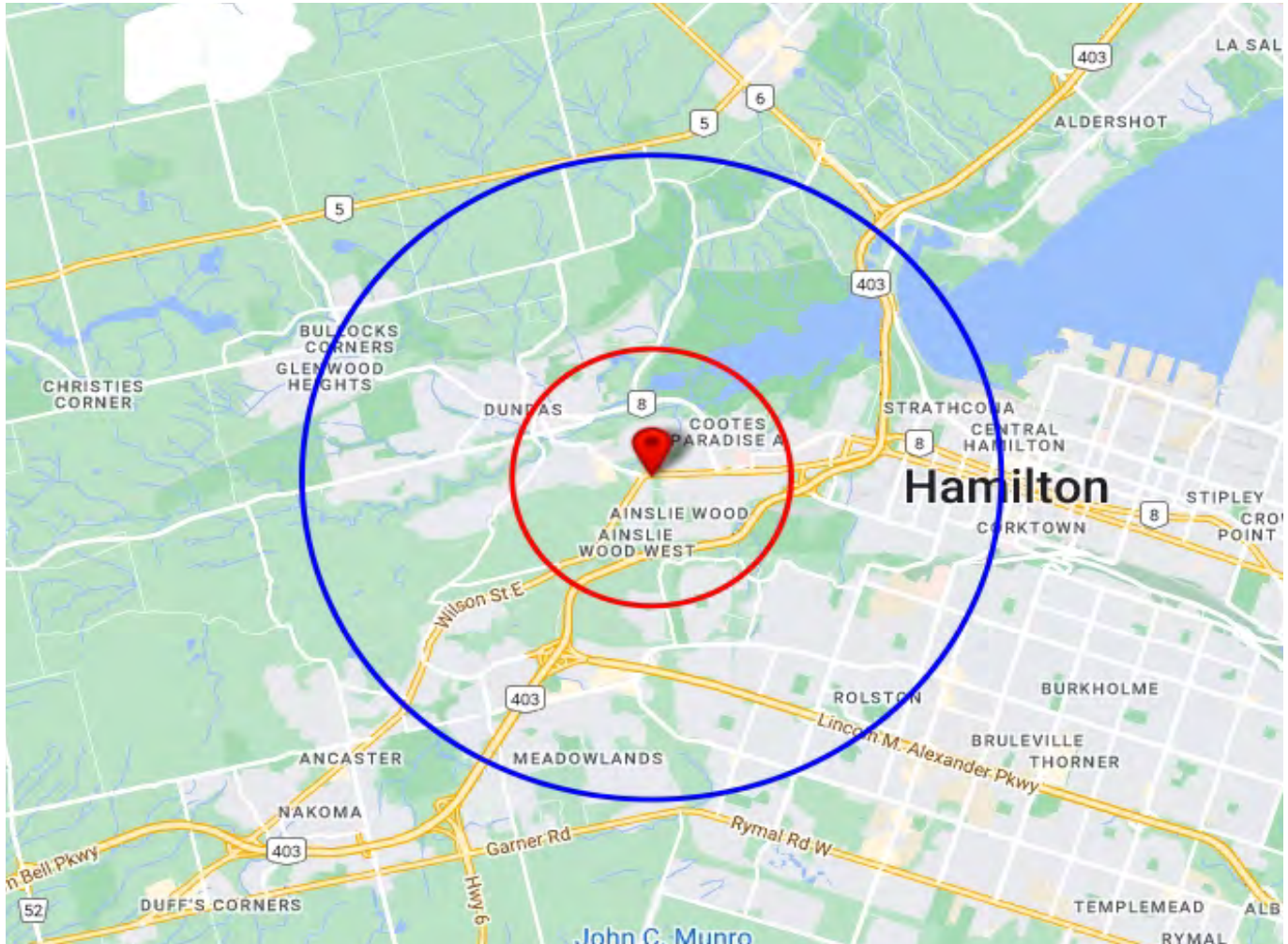

2022 Daytime Population	1685 Main St W, Hamilton, ON L8S 1G5 0 - 2 km		1685 Main St W, Hamilton, ON L8S 1G5 0 - 5 km	
		%		%
<b>Total Estimated Population</b>	<b>18,766</b>		<b>132,378</b>	
<b>Total Daytime Population</b>	<b>15,076</b>		<b>116,296</b>	
Daytime Population at Home	9,204	61.0%	64,660	55.6%
0 to 14 years	2,026	13.4%	17,960	15.4%
15 to 64 years	3,679	24.4%	24,784	21.3%
65 years and over	3,499	23.2%	21,916	18.8%
Daytime Population at Work	5,872	39.0%	51,636	44.4%
Work At Usual Place	4,023	26.7%	37,472	32.2%
Work Mobile	674	4.5%	5,463	4.7%
Work At Home	1,176	7.8%	8,701	7.5%



# DEMOGRAPHICS

## 1685 MAIN STREET WEST

2022 Demographic Snapshot	1685 Main St W, Hamilton, ON L8S 1G5 0 - 2 km		1685 Main St W, Hamilton, ON L8S 1G5 0 - 5 km	
		%		%
<b>Total Population</b>				
2017 estimated	17,387		125,910	
2022 estimated	18,766		132,378	
2027 Projected	20,137		139,675	
% Pop. Change (2017-2022)	7.9%		5.1%	
% Pop. Change (2022-2027)	7.3%		5.5%	
<b>2022 Total Population by Age</b>	<b>18,766</b>		<b>132,378</b>	
0 to 4 years	665	3.5%	5,672	4.3%
5 to 19 years	2,256	12.0%	19,431	14.7%
20 to 24 years	1,650	8.8%	9,649	7.3%
25 to 34 years	3,193	17.0%	20,343	15.4%
35 to 44 years	2,081	11.1%	16,634	12.6%
45 to 54 years	1,902	10.1%	15,207	11.5%
55 to 64 years	2,359	12.6%	17,517	13.2%
65 to 74 years	2,217	11.8%	14,787	11.2%
75 years & over	2,444	13%	13,139	10%
<b>Median Age</b>	42.5		41.5	
<b>2022 Total Census Families</b>	<b>4,346</b>		<b>33,463</b>	
Average Persons Per Family	2.8		3.0	
Total Couples	3,522	81.0%	27,496	82.2%
Without children at home	1,962	45.1%	13,116	39.2%
With children at home	1,560	35.9%	14,380	43.0%
Lone-parent families	824	19.0%	5,967	17.8%
Children Per Census Family	0.9		1.1	
<b>2022 Educational Attainment (15 years+)</b>	<b>15,791</b>		<b>110,706</b>	
Less than a bachelor degree	9,931	62.9%	71,845	64.9%
Bachelor degree & higher	5,860	37.1%	38,860	35.1%
<b>2022 Households</b>	<b>8,311</b>		<b>54,475</b>	
Persons per household	2.14		2.36	
Average household income	\$ 93,569		\$ 108,005	
<b>2022 Occupied Dwellings</b>	<b>8,311</b>		<b>54,475</b>	
Owned dwellings	4,310	51.9%	32,715	60.1%
Rented dwellings	4,001	48.1%	21,759	39.9%
Dominant building type	Houses		Houses	
Dominant period of construction	Before 1960		Before 1960	